

■ Note: When specifying/ordering grates, refer to "Choosing the Proper Inlet Grate" on pages 125-126.
 For a complete listing of FREE OPEN AREAS and WEIR PERIMETERS of all NEENAH grates, refer to pages 327-332.

NEW

R-3293-3
Triple Unit Frame, Grate, Curb Box

Heavy Duty

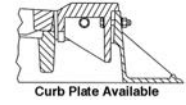
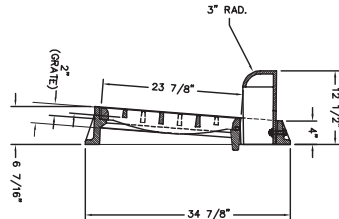
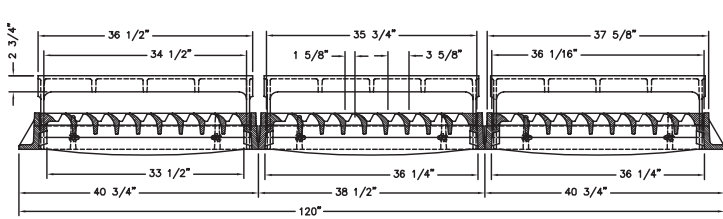

Standard Grate (shown): Type L
 Also available with grate Type C or Type R-diagonal.

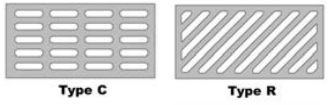

Available curb boxes: 2" radius (standard) and square
 Enviro-curb boxes available, see p. 129.



CATALOG NUMBER	GRATE TYPE	SQ. FT. OPEN	WEIR PERIMETER LINEAL FEET
R-3293-3	L	9.3	13.0
R-3293-3	C	6.6	13.0
R-3293-3	R	8.1	13.0

R-3295
Combination Inlet Frame, Grate, Curb Box

Heavy Duty

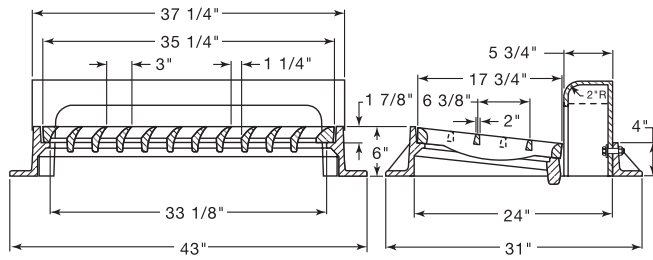

CATALOG NUMBER	GRATE TYPE	SQ. FT. OPEN	WEIR PERIMETER LINEAL FEET
R-3295	L	2.1	5.8
R-3295	C	2.1	5.8
R-3295	V	2.4	5.8

Standard Grate (shown): Type L
 Also available with grate Type V or Type C.

